

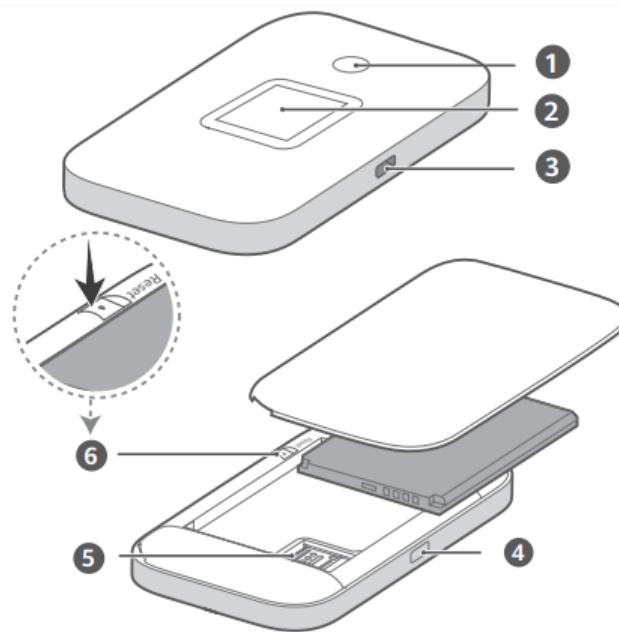

Product Overview



①	Power button	②	LCD screen
③	USB port	④	MENU button
⑤	SIM card slot	⑥	Reset button



Getting Started

Step 1: Inserting SIM card

Insert the SIM card into the slot with its chip side facing down and the notched side facing out.

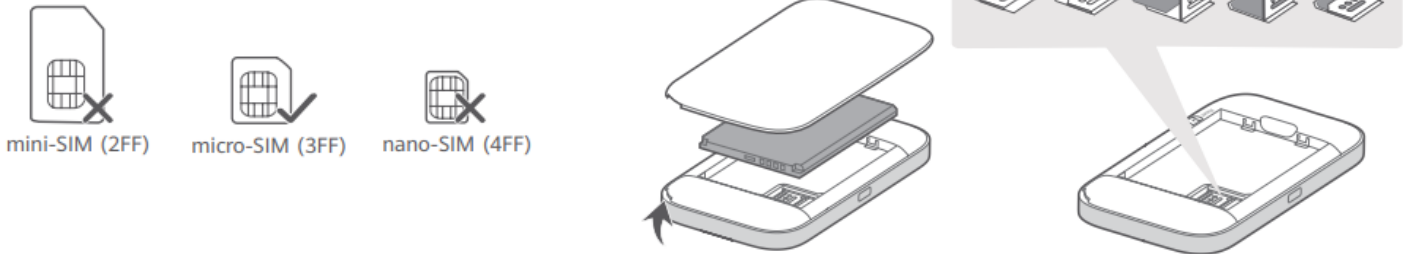

Step 2: Powering on/off the Mobile Wi-Fi

- Press and hold the Power button to power on the Mobile Wi-Fi. Your Mobile Wi-Fi searches for mobile network signals automatically after it is powered on.
- To power off the Mobile Wi-Fi: Press and hold the Power button until the LCD screen turns off.



Step 3: Connecting to your Mobile Wi-Fi network

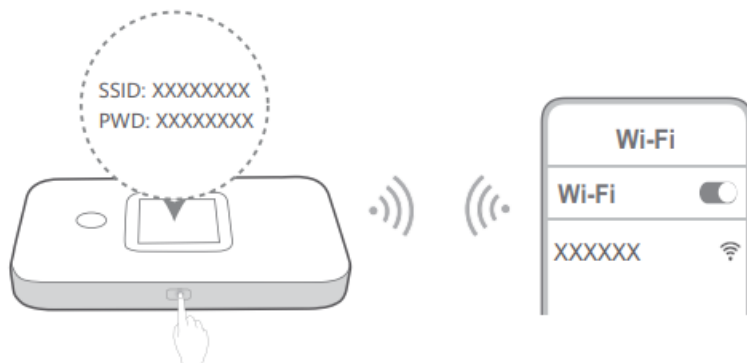



Mobile Wi-Fi (E5785-330)

- Once the Wi-Fi has connected to a mobile data network, you can connect your computer or any other Wi-Fi-capable device (E.g., smartphone, tablet, IoT) to the Mobile Wi-Fi network to access the Internet.
- Press the MENU button on your Mobile Wi-Fi to enter the menu screen and check the Wi-Fi@ network name (SSID) and password (PWD)
- Ensure that you promptly change the Wi-Fi network name and password on the web-based management page to prevent unauthorized access to your Wi-Fi network. Once you have changed the password, you will need to reconnect your device to the router's Wi-Fi network.

Step 4: Managing your Mobile Wi-Fi

- You can also manage your router using the device management app “Huawei AI Life”. The app is available for download from Huawei AppGallery, Google PlayStore or iOS AppStore. Scan the QR code below to download the app.



Basic Settings

1. How To Set Up APN

- Once you have connected to the Wi-Fi network, open up a web browser and go to web address **192.168.8.1**
- Enter the default password located at the back of the Wi-Fi (Note: The underlined example below is for reference. Please use the password that is written on your router.)

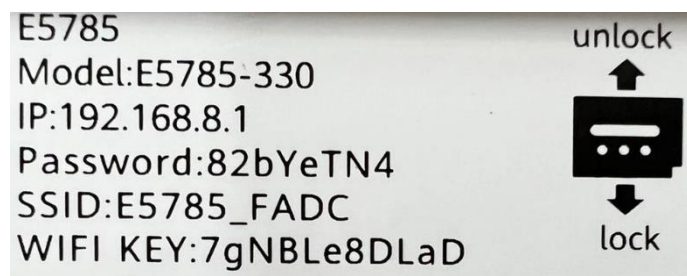

- Once successfully logged in, click on **Network Settings** on the menu bar.

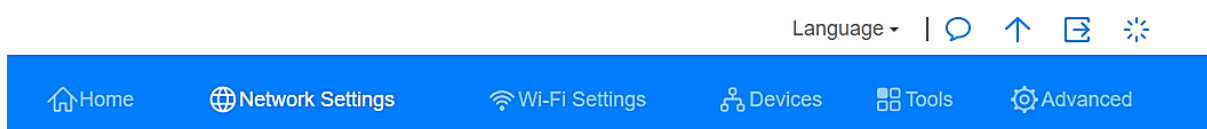



- Scroll down to 'Profiles' and click on the **Plus (+)** sign. Enter 'Vodafone PNG' as the Profile Name. Enter 'internet' as the APN. Tick the 'Set as Default Profile' box. Click 'Save'.

The screenshot shows the 'Profile Management' form with the following fields: Profile name (Vodafone PNG), Set as Default Profile (checked), APN (internet), User name (empty), and Password (empty). At the bottom, there are 'Cancel' and 'Save' buttons.

- Once done, you will see your newly created internet APN Profile.

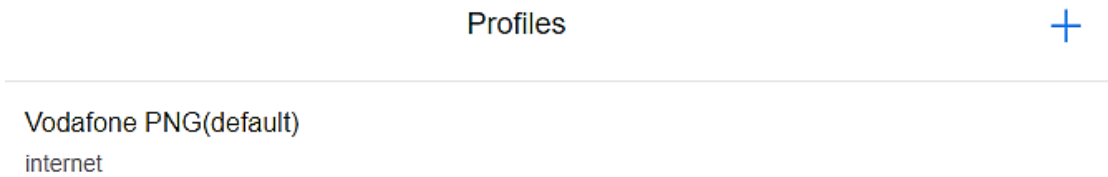

2. How To Change Network Mode

- Under 'Network Settings' menu, click on 'Mobile Network Sharing' located on the side menu.

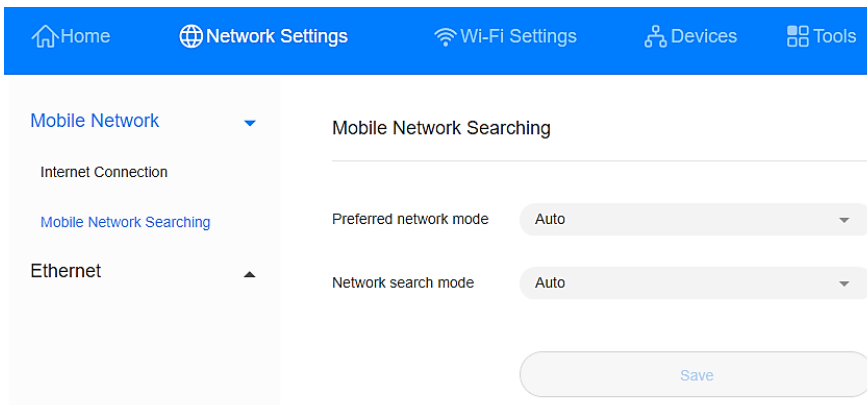

- From here, you can toggle between Auto, 4G Only and 3G Only on the Preferred Network Mode. It is recommended to keep the network mode locked to 'Auto' for a seamless experience.

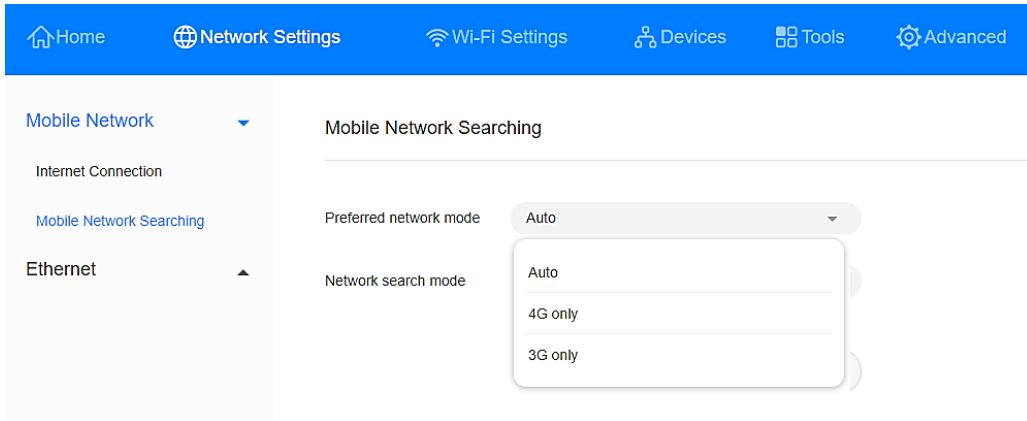

- Click 'Save' once done. This operation will disconnect the network and affect your data services. Services will be rebooted in 30 seconds – 1 minute.

3. How To Change Wi-Fi Name & Password

- Once you have connected to the Wi-Fi network, open up a web browser and go to web address **192.168.8.1**
- Enter your default password located at the back of the router
- Once successfully logged in, click on **Wi-Fi Settings** on the menu bar

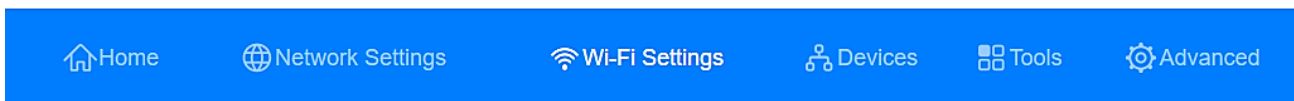

5 GHz preferred	<input checked="" type="checkbox"/>	
Wi-Fi	<input checked="" type="checkbox"/>	
2.4/5 GHz Wi-Fi name	<input type="text"/>	(2.4Ghz) To change Wi-Fi name/SSID, enter new name here
		<small>The optimal frequency will be used when 5 GHz preferred is enabled.</small>
Security mode	<input type="text" value="WPA2-PSK"/>	(2.4Ghz) To change Wi-Fi password, enter new password here
Wi-Fi password	<input type="password" value="....."/>	(5Ghz) To change Wi-Fi name/SSID, enter new name here
5 GHz Wi-Fi name	<input type="text"/>	
		<small>Connect to this Wi-Fi to use 5 GHz Wi-Fi only.</small>
Security mode	<input type="text" value="WPA2-PSK"/>	(5Ghz) To change Wi-Fi password, enter new password here
Wi-Fi password	<input type="password" value="....."/>	

- Click 'Save' to save and apply your new settings.

-----END-----